

TILLAMOOK COUNTY SURVEYORS OFFICE
COURTHOUSE, TILLAMOOK, OREGON 97141

1/4 CORNER COMMON SECTIONS 5 and 6 T.2S.R.9W., W.M.

1/4
T2S R9W
|
S6 + S5
|
1991

I found a 1 1/2" X 18" iron bar, approximately 3" deep in the left turn lane of U.S. Highway 101, (see Tillamook County Surveyors Rewitness Book 5 Page 201). I set a 5/8" X 12" iron rod with a 3" Tillamook County Surveyors Brass Cap in an 8" cast iron monument case and encased in concrete at the position of the found monument.

History of found monument

I found this monument to be as recorded in T.C.S. Rewitness Book 5 at page 201 and the references found and/or set at that time to now be as follows:

OSH R/W post & pin N.57 W. 52.93', shown on T.C.S. map #F-27-8 as 53.29', Reported in 1980 as N.60 W. 53.55' in same book and page; (Found, at the 1980 position. The pin is located 0.8' SE of the hat section post. The R/W post is rotted off).

OSH 1/4 cor post & pin S.76 30'W. 103.03', shown on T.C.S. map #F-27-8 as 102.98'; (Found bent, I straightened and reset in same hole, now 102.98'. The post is gone).

OSH R/W post & pin N.76 30'E. 76.18', shown on T.C.S. map #F27-8 as 76.92', reported in 1980 as 77.22' in same book and page; (Now gone).

New Accessory

*72" hat section post N.60 W. 54.1'.

Tack in the top of a 4"X 4" corner fence post N.76 E. 77.9'.

*indicates Tillamook County Surveyors yellow metal location poster attached.

Reference Surveys and Rewitnesses

A-3538	July 1978	John L. Carlich	RS 287
A-3558	Aug 1978	C. Wayne Cook	RS 1098
B-215	July 1916	R.L. Shreve	CS
A-3296	Apr 1977	John L. Carlich	RS 287
B-612	Nov 1971	John L. Carlich	RS 287
A-2782	Apr 1975	John L. Carlich	RS 287
A-2513	Jan 1974	John L. Carlich	RS 287
B-75	2-19 thru 21-21	W.E. Anderson	Dep. CS
A-159	Nov. 1937	W.E. Anderson	PE 1697
F-27-7	Aug. 1946	J.H. Scott	PE
F-27-8	10-20-50	Arthur Duffy	RE
F-14-29		O.S.H.D.	
F-27-19		O.S.H.D.	
F-40-309	Mar. 1964	O.S.H.D.	
G.L.O. Book 2S9 Page 26 & 27	9-20-1857	Cont. #67	
Survey Book "S3" Page 428	2-21-03	A.M. Austin	
Field Notebook "AMA 5" Page 23	2-21-03	A.M. Austin	
Rewitness Book 4 Page 7	2-21-03	A.M. Austin	
Field Notebook "AMA 10" Page 51	8-19-1895	A.M. Austin	
Rewitness Book 1 Page 83	8-1949	W.E. Anderson	CS
Rewitness Book 4 Page 61	8-1949	W.E. Anderson	CS
Rewitness Book 5 Page 201	4-20-66	John L. Carlich	RS 287

Location of Monument

This monument is located in the left turn lane of U.S Highway 101 at the intersection of long Prairie County Road, Geinger County Road, and U.S. highway 101.

In the presence of Al Dvorak and Dan McNutt

October 8, 1991

Title:

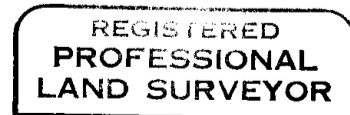
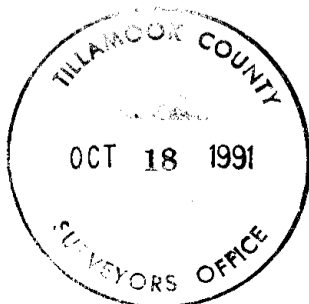

Allan E. Duncan, C.S.

